

**MAKARDAH ROAD  
(12192 MM WIDE)**

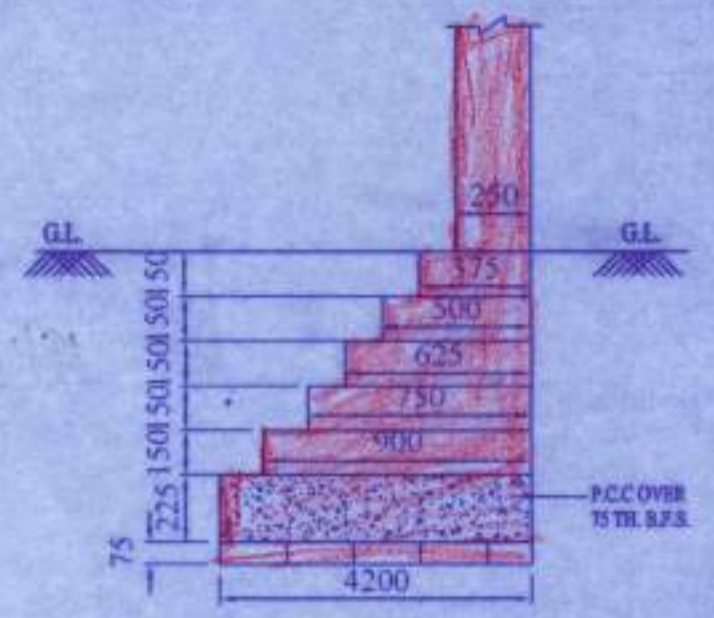

**DETAIL OF 250 THK. RETAINING WALL  
SCALE - 1:600**



**NOTES:**

1. ALL DIMENSIONS ARE IN MILLIMETRES UNLESS OTHERWISE SPECIFIED.
2. WRITTEN DIMENSIONS TO BE FOLLOWED.
3. ANY AMBIGUITY IN THE DRG. SHOULD BE IMMEDIATELY BROUGHT TO THE NOTICE OF THE CONSULTANT BEFORE COMMENCING THE WORK.
4. THIS DRAWING IS SANCTION PURPOSE ONLY.

**DOOR WINDOW SCHEDULE**

**SHEET NO - 2 OF 7,**

NO.	WIDTH	SILL HT.	ENTEL HT.	REMARKS
D1	1500	00	2100	WOODEN FLUSH DOOR
D2	1050	00	2100	WOODEN FLUSH DOOR
D3	900	00	2100	WOODEN FLUSH DOOR
D4	750	00	2100	P.V.C. FLUSH DOOR
W1	1500	300	2100	ALUMINIUM SLIDING WINDOW
W2	1500	750	2100	ALUMINIUM SLIDING WINDOW
W3	1200	750	2100	ALUMINIUM SLIDING WINDOW
W4	900	750	2100	ALUMINIUM SLIDING WINDOW
W5	900	1050	2100	ALUMINIUM SLIDING WINDOW
W6	400	300	2100	ALUMINIUM SLIDING WINDOW
W7	400	1500	2100	ALUMINIUM SLIDING WINDOW
DW	1800	00	2100	ALUMINIUM SLIDING DOOR WINDOW
FCD	1050	00	2100	FIRE CLOSED DOOR

**CERTIFICATE OF STRUCTURAL ENGINEER**

THE STRUCTURAL DESIGNS AND DRAWINGS OF BOTH FOUNDATION AND SUPERSTRUCTURE OF THE BUILDING HAS BEEN MADE BY ME CONSIDERING ALL POSSIBLE LOADS INCLUDING THE SEISMIC LOAD AS PER NATIONAL BUILDING CODE OF INDIA AND CERTIFY THAT IT IS SAFE AND STABLE IN ALL RESPECTS

*Ar. N. Ghosh*  
**AR. N. GHOSH**  
B. Tech. (Struct. Engg.)  
Chartered Engineer (AM-149134-5)  
Howrah Municipal Corporation  
Structural Engineer (ESE/SE-1147)  
M-947-460988 / 820584751

**SIGNATURE OF STRUCTURAL ENGINEER**

**CERTIFICATION OF ARCHITECT**

I CERTIFY THAT THE BUILDING PLAN HAS BEEN DRAWN UP AS PER PROVISION OF THE KOLKATA MUNICIPAL CORPORATION BUILDING RULES 2009 AS AMENDED FROM TIME TO TIME, THE SITE CONDITION INCLUDING THE WIDTH OF THE ABUTTING HOWRAH MUNICIPALITY ROAD OF 30 M (AVERAGE R.O.W.) ON NORTH HAS BEEN CONFIRMED WITH THE PLAN, IT IS A BUILDABLE SITE, NOT A TANK OR FILLED UP TANK, SITE MEASUREMENT IS AS PER REGISTERED BOUNDARY DECLARATION.

*Ar. Minto Paul*  
**Ar. Minto Paul**  
Govt. Regd. Architect (India)  
L.R.A. No. CA/2002/29737  
8, Duttly, Andul, Howrah - 711309

**SIGNATURE OF ARCHITECT**

**SIGNATURE OF APPLICANT**

I / WE DO HEREBY DECLARE THAT I / WE SHALL ARRANGE THE TREE COVER AS SHOWN IN THE DRAWING WHICH IS RAISED AND MAINTAINED BY ME AT MY OWN COST.

- 1) KALPANA SARKAR
- 2) APURBA KUNDU
- 3) APURBA KUNDU
- 4) PARBATI KUNDU
- 5) DEBIKA DEBI LA KUNDU
- 6) SHILA DEBI
- 7) DEB KUMAR KUNDU
- 8) SAMIR KUMAR KUNDU
- 9) PRADIP KUMAR KUNDU
- 10) TAPATI KUNDU
- 11) KRISHNENDU KUNDU
- 12) SOUTI SRIMANI
- 13) SUNANDA SRIMANI
- 14) SUKANTA SRIMANI
- 15) SUTAPAN DEVI
- 16) RAJ KUMAR KUNDU CHOWDHURY
- 17) RAJ KUMAR KUNDU CHOWDHURY
- 18) BREE KUMAR
- 19) NUPUR SRIMA
- 20) NUPUR SRIMA
- 21) SUMER PAL
- 22) SOUVENDU KUNDU
- 23) SANJAY PAL
- 24) DEBARAJA RAMU
- 25) ATISH PRASAD MONDAL
- 26) ALOK KUNDU
- 27) MALYASH KUNDU
- 28) ARKABRATA KUNDU
- 29) MAHESH SETHI GUPTA
- 30) KUSHAL KUMAR GUPTA
- 31) ROHIT KUMAR GUPTA
- 32) PARTNER'S M.A.B. & ASSOCIATES

**SIGNATURE OF APPLICANT**

**TITLE**

**ELEVATION, SECTIONS, FLOOR PLAN & ROOF PLAN**

**PROJECT**

**PROPOSED G+12 STORIED RESIDENTIAL COMPLEX AT HOLDING NO.-19, KANTA PUKUR THIRD BYE LANE NOW ASHIM ROY SARANI, L.R.DAG. NO.-128,129,130,131,132,133,134,206,207, 208,209,220,221,222,223,L.R.KHATIAN NO.-365,369, 370,371,372,373,374,375,376,377,378,379,380,381,382, 383,384,385,386,391,396,398,399,401,402,403,404,405, 406,MOUZA-BANTRA,J.L. NO.-1, P.O- KADAMTALA, P.S- BANTRA, DIST- HOWRAH, PIN.-711101, UNDER WARD NO-23, OF HOWRAH MUNICIPAL CORPORATION.**

ALL THE DIMENSIONS ARE IN MM **SCALE = 1:100, 25:50:100:200:500:1000**



H.M.C.S.EAL

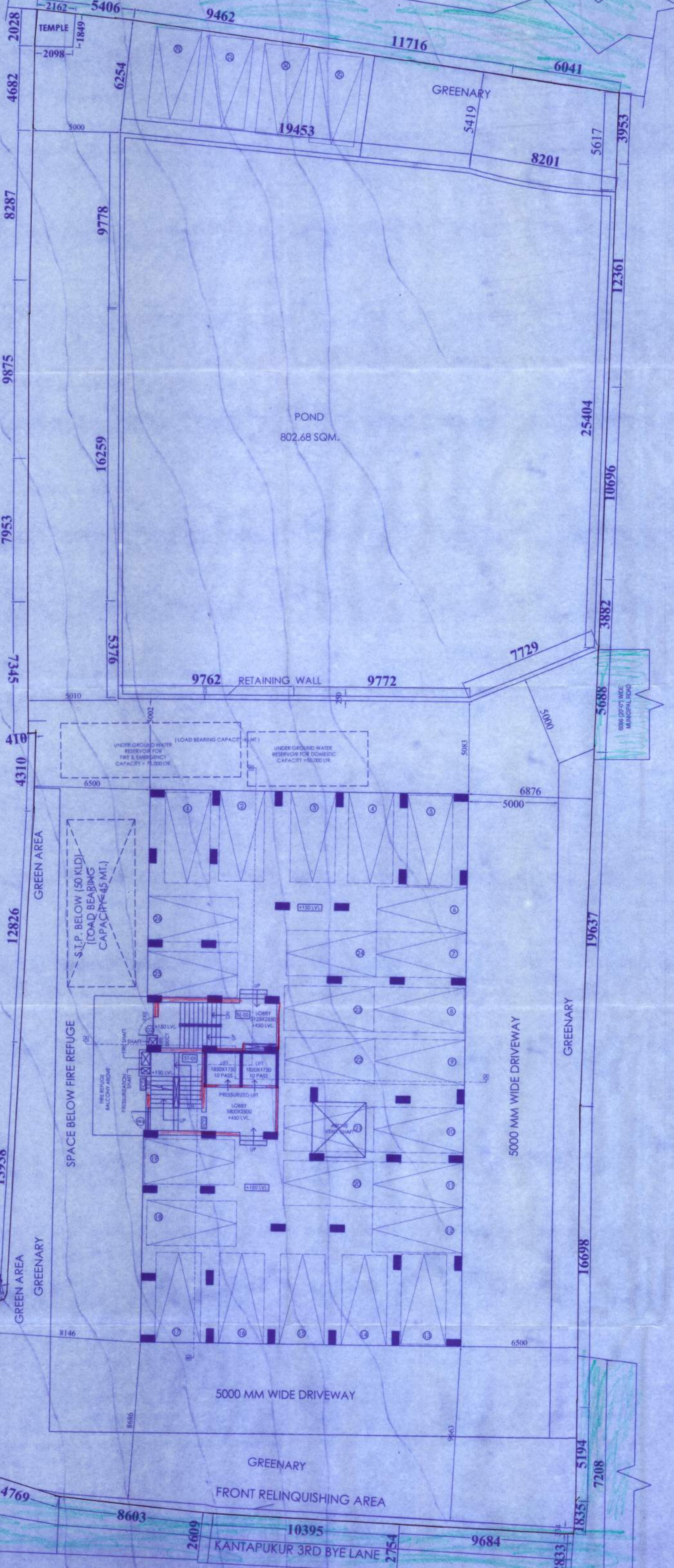

**ON SITE GROUND FLOOR PLAN  
SCALE-1:100**



APPLICANT HAS TO EXHIBIT AT A CONSPICUOUS PLACE  
PREMISES NO. :-  
NAME OF THE LBA, LBS :-  
NAME OF THE STRUCTURAL ENGG. :-  
NAME OF THE GEO-TECHNICAL ENGINEER :-  
NAME OF THE OWNER :-  
NAME OF THE APPLICANT :-  
PROVIDING PERMIT

CERTIFIED COPY



CORRECTION PLAN 23  
BRC No. 122-23 Ward No. 12  
Date 14/12/24  
Sub. Asst. Engineer  
Sdg. Department  
Howrah Municipal Corporation

Structural plan and design calculation as submitted by the structural engineer have been approved by the B.P. No. 122-23 Date 14/12/24 for record of the Howrah Municipal Corporation without verification. No deviation from the submitted structural plan should be made at the time of erection without submitting fresh structural plan along with design calculation and stability certificate in the prescribed form, necessary steps should be taken for the safety of the adjoining premises, public and private properties and safety of Human Life during construction.

*[Signature]*  
Assistant Engineer  
Building Department  
Howrah Municipal Corporation

PLACED IN MUNICIPAL BUILDING COMMITTEE  
DATED 14/12/24

Sanctioned subject to existing structure to provide open space as per plan before construction is started.

Before starting any construction site must conform with the sanctioned and all the conditions proposed in the plan should be fulfilled.

The validity of the written permits to execute the work is subject to above conditions.

The Building Materials necessary for construction should conform to standard specified in the National Building Code of India.

Re-Erection within Two Year will Require Fresh Application for Sanction.

Design of all structural Members including that of the foundation should conform to Standard specified in the National Building Code of India.

RESIDENTIAL BUILDING

DEVIATION WOULD MEAN DENULCATION

Necessary steps should be taken for the safety of the lives of the adjoining public and private properties during construction. Also to avoid pollution as per WSPCA Guidelines in VAGUE.